

# FLATSPOT-7 LED - F030 - 250mA 9,9W - LEDXOB2700K/3000K SNAP LENS Ø3524°/38° - IP20

External driver  
U > 28V DC  
I < 250mA

- ALL LOW VOLTAGE PRODUCTS REQUIRE THE USE OF A SUITABLE RATED TRANSFORMER

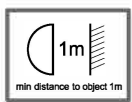

A<sub>1x</sub>

D<sub>2x</sub>

B<sub>1x</sub>

C<sub>2x</sub>

E<sub>2x</sub>

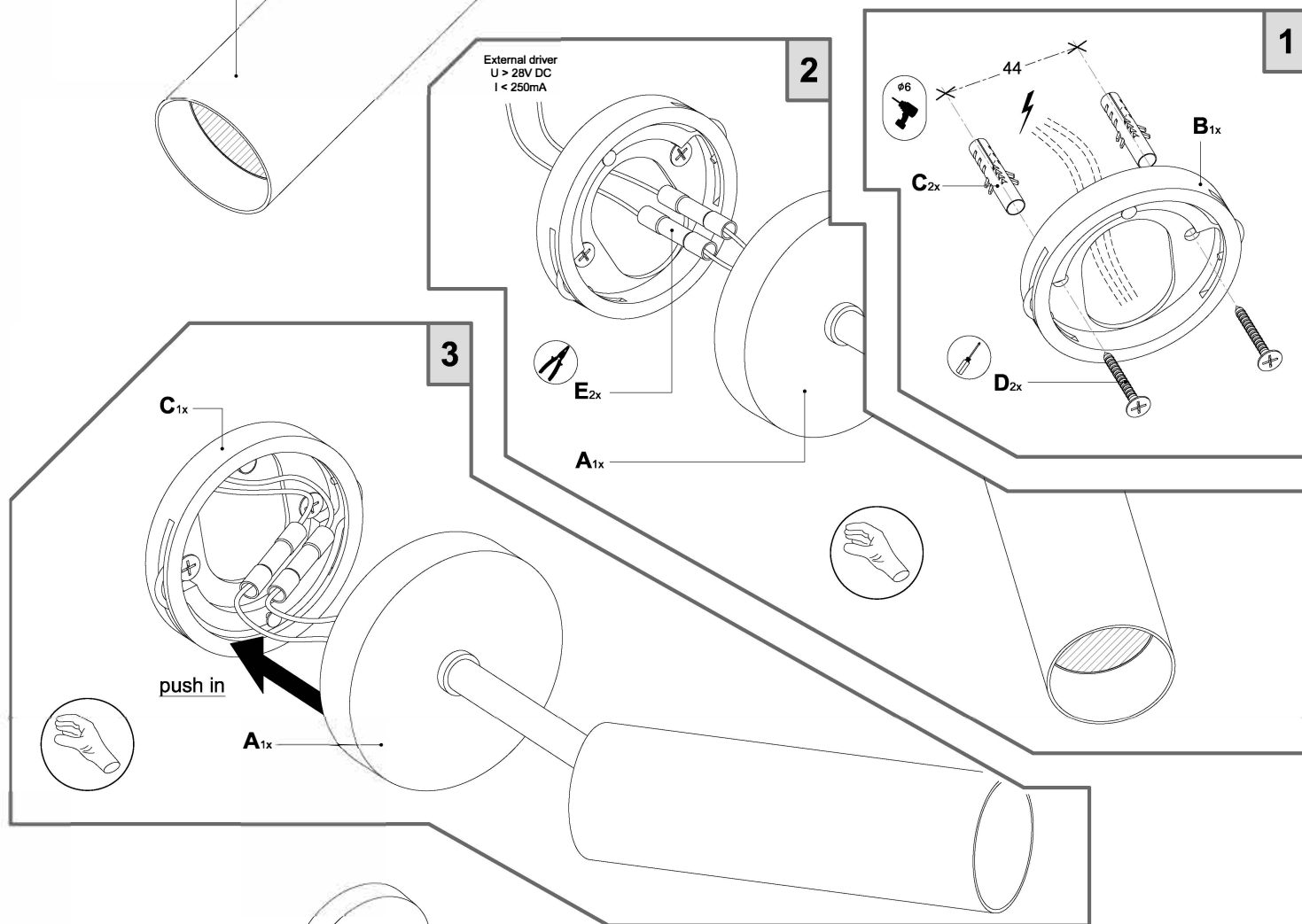

External driver  
U > 28V DC  
I < 250mA

2

1

3

push in

A<sub>1x</sub>

C<sub>1x</sub>

E<sub>2x</sub>

A<sub>1x</sub>

D<sub>2x</sub>

B<sub>1x</sub>

96

44



## INFO

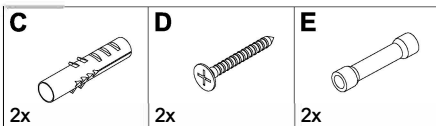

- NL Veiligheidsvoorschriften**  
Schakel de netspanning uit - om veiligheidsredenen - vooraleer u de FLATSPOT-7 LED installeert.
- F Instructions de sécurité**  
En cas d'entretien et réglage de la lampe FLATSPOT-7 LED couper la tension.
- GB Safety instructions**  
In case of maintenance and adjustment of the lamp FLATSPOT-7 LED switch off the power
- D Sicherheitsanleitung**  
Für die Wartung der Leuchtmittel FLATSPOT-7 LED die Spannung abschalten.
- E Instrucciones de seguridad**  
En caso de mantención y regulacion de la lámpara FLATSPOT-7 LED sacar la tensión.
- I Istruzioni di sicurezza**  
In caso di manutenzione e regolazione lampadina FLATSPOT-7 LED togliere tensione.

rev.00